



MARIGOLD

at NAVAPARK

If you could live anywhere,
where would it be?



MARIGOLD 7

The Final Tower

Sitted on top of the Botanic Park inside NavaPark, Marigold offers panoramic view of blue sky and vast greeneries. Residents can live and work with uninterrupted view, enjoy healthy living at the Botanic Park, and relish in abundant facilities at the Country Club.



Facilities

- Gym
- infinity & Kids Pool
- Function hall
- Mini mart
- Indoor & outdoor Playground
- Jogging & Cycling track
- Spring Lake
- BBQ Pit
- Camping Ground
- Panoramic Viewing Deck
- Golfer Park

1 Bedroom

SGA
50,25 SQM

NET AREA
43,11 SQM

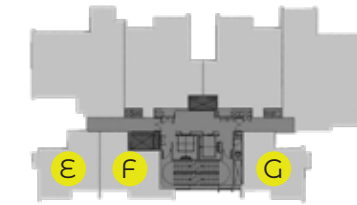

2 Bedroom Suite

SGA
91,51 SQM

NET AREA
80,55 SQM

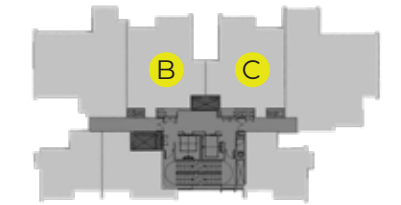

2 Bedroom + Study

SGA
110,44 SQM

NET AREA
95,03 SQM

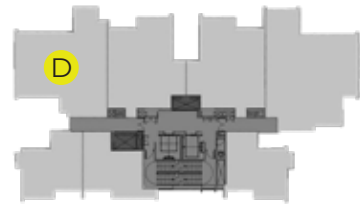

3 Bedroom Premium

SGA
131,01 SQM

NET AREA
112,21 SQM

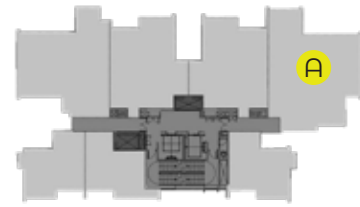

Special Features

- Low density with 7 UNITS PER FLOOR
- Semi furnished with AC, BATHROOM VANITY, kitchen set & cabinet
- DOUBLE LAYERED WALL BETWEEN UNITS
- MARBLE flooring for LIVING and DINING area
- LAMINATED FLOORING for bedroom
- 1:1 parking ratio
- 4 LAYERS SECURITY
- Electronic DOOR lock



Great neighborhood inside the prestigious NavaPark

Marigold is located inside NavaPark—the most prestigious area in BSD City. A development that is surrounded by Aeon Mall BSD, The Breeze, ICE BSD, Sinarmas World Academy, Prasetiya Mulya, and Eka Hospital. Be a part of NavaPark higher living.



MARKETING GALLERY

Jl. Grand Boulevard BSD City
Tangerang Selatan
Indonesia

CONTACT

T. 021-2958 0282
WA. 0881 7787 877
W. navapark.id

DEVELOPED BY



DISCLAIMER

Neither the Developer nor its agents will be held responsible for any inaccuracies or omissions in the information contained in this brochure. The Developer does not accept responsibility for any errors or omissions or for any losses suffered by any person or legal entity resulting from the use of the information contained in this brochure, howsoever caused. The statements, visual representations, models, show units, displays and illustrations, photographs, art renderings and other graphic representations and references are intended to portray only artist impressions of the development and décor and cannot be regarded as accurate or representations of fact. All areas and other measurements are approximate measurements and are subject to change and final survey. All plans and models are not to scale unless expressly stated and are subject to amendment. All information, specifications, renderings, visual representations, measurements and plans are subject to change as may be required by us and/or the relevant authorities. The Sale and Purchase Agreement (SPA, also known as PPJB) shall form the entire agreement between the Developer and the Purchaser and shall supersede all statements, representations or promises made prior to the signing of the SPA and shall in no way be modified by any statements, representations or promises made by us or our agents which are not embodied in the SPA, whether before or after the signing of the SPA. Any explanation concerning the SPA and the development is for information purposes only and it is recommended that potential Purchasers seek independent legal advice with regard to the proposed purchase. Marble and granite are natural stone materials containing veins with tonality differences. There will be colour and markings caused by their complex mineral composition and incorporated impurities. While such materials can be pre-selected before installation, this non-conformity in the marble or granite cannot be totally avoided. Granite tiles are pre-polished before laying and care has been taken for their installation. Hence some differences may be felt at the joints. The tonality pattern of marble or granite selected and installed shall be subject to availability. Timber is natural material containing veins and tonal differences. Thus it is not possible to achieve total consistency of colour and grain in its selection and installation. Layout/location of kitchen cabinets, fan coil units and electrical points are subject to Developer's sole discretion and final design.